





The St David

Vibrant and refined, this is vivacious, full-of-life vacationing. A contemporary colour pop here, a stylish statement piece there. Every detail is tastefully curated for a breakaway to be enjoyed in style. Pour yourself something refreshing and perfectly chilled, then take in every sumptuous moment spent in surroundings filled with splendour.



Styled with sophistication

Please note: Some items featured in this photography are scene-setting props or optional extras, not included in your purchase. Please speak to your park or dealership or refer to the 'all this included' section for this holiday home.



Shows optional full front sliding door, see page 35



Highlights:

- Brand new layout and colour scheme for 2026
- Spacious family home
- All models include an en suite toilet
- En suite with shower in the 38ft x 12ft 2 bedroom model
- Home-from-home styling
- New feature fireplace



The St David

Choose from two irresistible layouts, each is expertly crafted for holidays enjoyed in fine style.



For more information and to take a virtual tour, visit www.abiuk.co.uk

All this included

- ✓ Matt finish Champagne aluminium cladding
- ✓ Carpet underlay throughout
- ✓ Stylish light fittings with low energy bulbs
- ✓ Luxury wood burner style feature fire
- ✓ USB socket in lounge
- ✓ Additional sockets next to TV point in lounge
- ✓ Free-standing dining table and chairs
- ✓ Externally vented powered cooker hood
- ✓ 40mm worktops
- ✓ Soft-close hinges on doors and drawers in kitchen
- ✓ Lift-up bed in master bedroom
- ✓ King size bed in master bedroom (2 bedroom model only)
- ✓ TV point in master bedroom and one twin room
- ✓ USB sockets in all bedrooms
- ✓ En suite shower (38ft x 12ft 2 bedroom model only)
- ✓ Bathroom extractor fans
- ✓ Separate en suite toilet
- ✓ Hooks in all bathrooms
- ✓ Composite kitchen sink
- ✓ Coffee table with cube stool
- ✓ Crib 5 mattresses to all bedrooms

Add any of these

- ☐ Fully galvanised chassis
- ☐ 'Low E' PVCu Thermaglass argon-filled double glazing
- ☐ Winter premium pack
- ☐ Winter electric pack
- ☐ Voiles throughout
- ☐ Free-standing fridge
- ☐ Free-standing or integrated fridge freezer
- ☐ Integrated microwave oven
- ☐ Integrated dishwasher or washing machine
- ☐ Plain duvet covers and pillowcases
- ☐ Scatter cushions in lounge
- ☐ Exterior door options available
- ☐ Bluetooth sound system in lounge
- ☐ 'Exclusive' pocket sprung mattresses
- ☐ Space saver bed (twin room only)

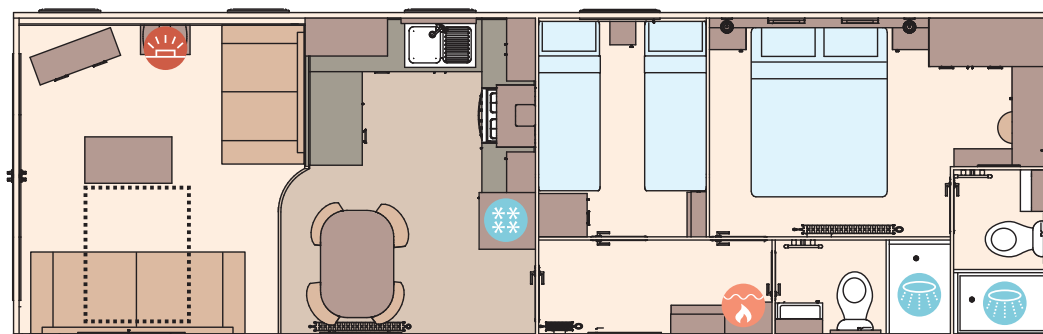

The St David 38ft x 12ft x 2 bedroom

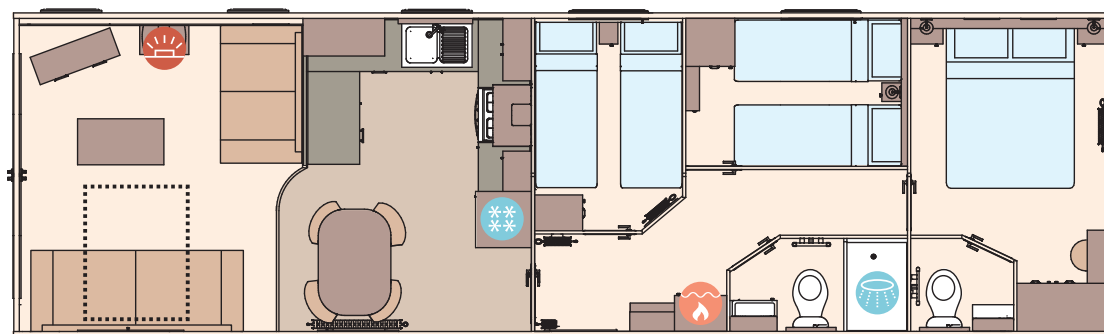

The St David 40ft x 12ft x 3 bedroom

KEY:

- Fire
- Water heater
- Shower
- Fridge/Freezer
- Front pull out bed

OPTIONAL
WINTER
PACKS
See Page 86