





The Balmoral

Entertain in grand surroundings. Lose yourself in the irresistible luxe of an indulgent living space, where fine dining and gregarious gatherings can last long into starry-filled nights. Or find sanctuary in the impossible-to-resist lure of hotel-suite style bathrooms, adorned with new royal blue feature tiles. Give in to the temptation of sinking into getting-away-from-it-all escapism, waiting to be discovered at every turn.



Irresistible luxury living

Please note: Some items featured in this photography are scene-setting props or optional extras, not included in your purchase. Please speak to your park or dealership or refer to the 'all this included' section for this holiday home.





Highlights:

- Opulent feature window
- Optional deluxe NEFF kitchen appliances
- Natural contemporary feature slatted wall panelling
- Bathroom with all-in-one GRP bath



The Balmoral

Looking for delightful details on a grand scale? Choose from two exceptional holiday home layouts, each one is fit for a king.

For external CanExel™ Cladding option please visit www.abiuk.co.uk



For more information and to take a virtual tour, visit www.abiuk.co.uk

All this included

- ✓ Fully galvanised heavy-duty chassis
- ✓ Chateaux Grey PVCu cladding
- ✓ Front sliding patio doors
- ✓ White 'Low E' PVCu Thermaglass argon-filled double glazing
- ✓ Carpet underlay throughout
- ✓ Fully condensing boiler gas central heating
- ✓ Stylish domestic sofas
- ✓ Upholstered footstool
- ✓ Free-standing dining table and 4 chairs
- ✓ Scatter cushions in lounge
- ✓ USB socket in lounge
- ✓ Satellite co-ax
- ✓ Additional sockets next to TV point in lounge
- ✓ 5 burner gas hob including wok burner
- ✓ Composite kitchen sink
- ✓ Free-standing American-style fridge freezer
- ✓ Integrated dishwasher
- ✓ Integrated microwave oven
- ✓ Externally vented powered cooker hood
- ✓ Soft-close hinges on doors and drawers throughout
- ✓ Lift-up bed in master bedroom
- ✓ King size bed in master bedroom
- ✓ Plain duvet covers and pillowcases
- ✓ Bed runners and scatter cushions on all beds
- ✓ USB sockets in all bedrooms (includes USB sockets

to both sides of the main bed)

- ✓ TV point in all bedrooms
- ✓ Luxury en suite with all-in-one GRP bath
- ✓ Bathroom extractor fans
- ✓ Shaver socket
- ✓ Hooks in all bathrooms
- ✓ Wicker storage baskets in kitchen
- ✓ Stylish round and oval mirrors in all bedrooms, bathroom and en suite
- ✓ Crib 5 mattresses to all bedrooms
- ✓ High quality internal door frames and doors

Add any of these

- ☐ Residential specification BS3632
- ☐ Deluxe Bluetooth sound system
- ☐ Deluxe NEFF appliances including microwave, oven and hob and extractor hood
- ☐ 'Exclusive' pocket sprung mattresses
- ☐ Space saver bed for twin room
- ☐ Integrated washing machine

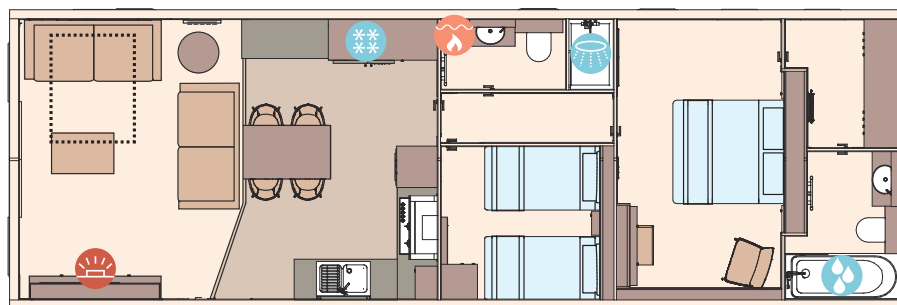

The Balmoral 43ft x 14ft x 2 bedroom

KEY:

- Fire
- Water heater
- Shower
- Bath
- Fridge/Freezer
- Front pull out bed

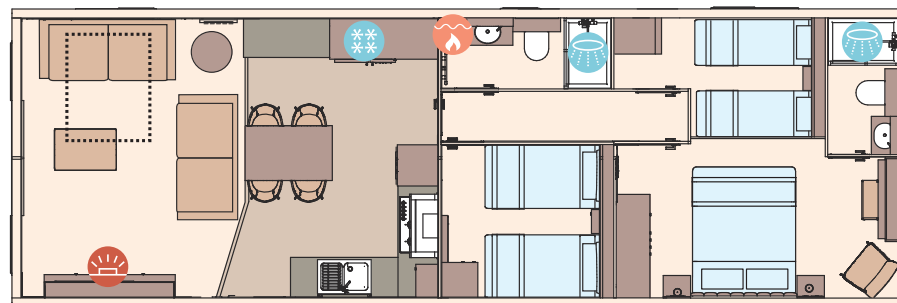

The Balmoral 43ft x 14ft x 3 bedroom

OPTIONAL
Residential
specification
BS3632
See Page 86