





Shows optional internal capping (Residential spec only), see page 59

The Ingleton

Relaxation refined. Let keen eyes settle on sophisticated style notes that provide subtle hints of the elegant ambience you're about to reside in. Pamper in plush textures, sleek features and modern finishes, within the chicest of spaces that just oozes elegance and calm.



Shows optional internal capping (Residential spec only), see page 59



Shows optional internal capping (Residential spec only), see page 59

Elegant ambience abounds

Please note: Some items featured in this photography are scene-setting props or optional extras, not included in your purchase. Please speak to your park or dealership or refer to the 'all this included' section for this holiday home.



Shows optional internal capping (Residential spec only), see page 59





Highlights:

- Feature fireplace in lounge
- Open-plan family holiday home with breakfast bar
- Option to upgrade to BS3632 residential specification



Shows optional internal capping (Residential spec only), see page 59

The Ingleton

If this holiday home's chic style is for you, there's only one decision left. Which of the two elegant layouts will you choose?



For more information and to take a virtual tour, visit www.abiuk.co.uk

All this included

- ✓ Matt finish Chateaux Grey aluminium cladding
- ✓ Pre-galvanised twin axle chassis
- ✓ White 'Low E' PVCu Thermaglass argon-filled double glazing
- ✓ Fully condensing boiler gas central heating
- ✓ Free-standing dining table and 4 chairs
- ✓ Breakfast bar
- ✓ Breakfast style stools
- ✓ Satellite co-ax
- ✓ USB socket in lounge
- ✓ Scatter cushions in lounge
- ✓ Soft-close hinges on doors and drawers in kitchen
- ✓ 40mm worktops
- ✓ Integrated fridge freezer
- ✓ Externally vented powered cooker hood
- ✓ Lift-up bed in master bedroom
- ✓ TV point in all bedrooms
- ✓ USB sockets in all bedrooms
- ✓ King size bed in master bedroom (2 bedroom model only)
- ✓ Separate en suite toilet and shower in all models
- ✓ Bathroom extractor fans

- ✓ Shaver socket
- ✓ Additional sockets next to TV point in lounge
- ✓ Hooks in all bathrooms
- ✓ Composite kitchen sink
- ✓ Full front sliding door
- ✓ Crib 5 mattresses to all bedrooms
- ✓ Contemporary radiator in lounge

Add any of these

- ☐ Residential specification BS3632
- ☐ Deluxe Bluetooth sound system
- ☐ 'Exclusive' pocket sprung mattresses
- ☐ Space saver bed for twin room
- ☐ Integrated washing machine
- ☐ Integrated dishwasher
- ☐ Integrated microwave oven
- ☐ Fully galvanised chassis
- ☐ CanExel™ exterior cladding
- ☐ Upgrade to Graphite Grey windows with matching internal capping (available on BS3632 upgrade)
- ☐ Voiles throughout

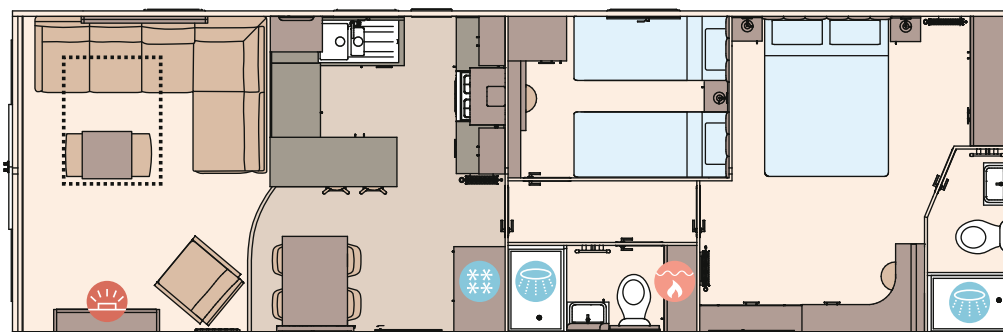

The Ingleton 40ft x 13ft x 2 bedroom

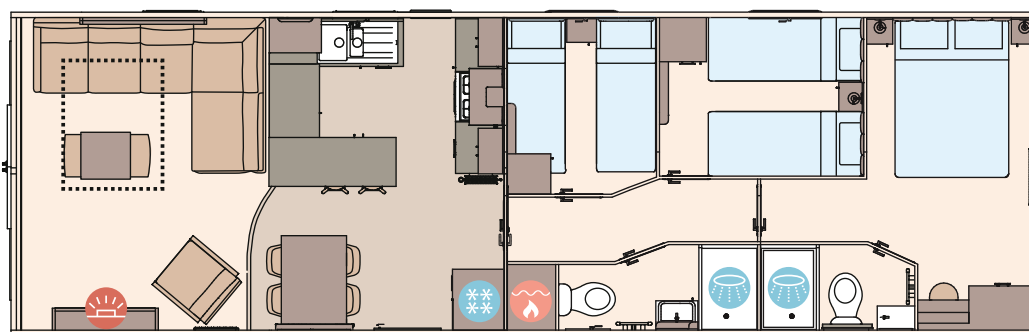

The Ingleton 41ft x 13ft x 3 bedroom

KEY:

- Fire
- Water heater
- Shower
- Fridge/Freezer
- Front pull out bed

OPTIONAL
Residential
specification
BS3632
See Page 86

OPTIONAL
WINTER
PACKS
See Page 86