







# The Langdale

A natural break. Feel the call of the cuddle chair and curl up in comfort. Let bare feet pad around in softness and serenity, where forest-feel tones make it all too easy to nestle down. Find grounding in the glow of the new wood-burning fireplace, and soak up the quiet energy of the outdoors through windows that frame every view from crisp mornings to dusky evenings. And breathe.





## *Soft, serene surroundings*

Please note: Some items featured in this photography are scene-setting props or optional extras, not included in your purchase. Please speak to your park or dealership or refer to the 'all this included' section for this holiday home.



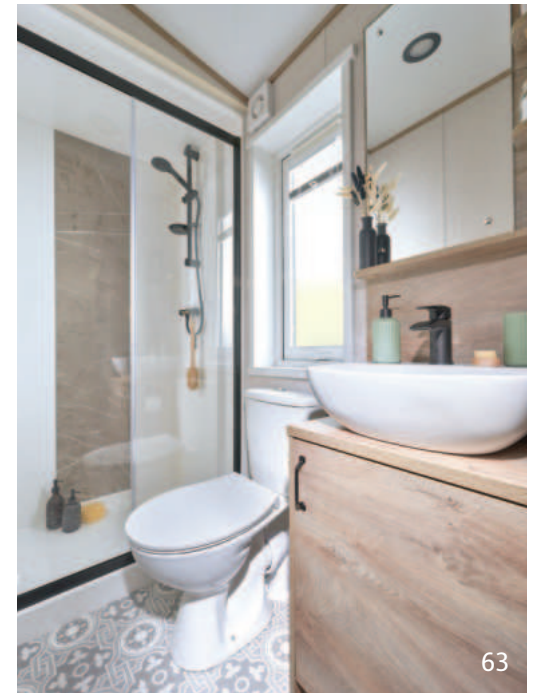





### Highlights:

- Updated colour scheme for 2026
- Wood burner style fireplace
- Free-standing domestic style seats
- Modern spacious kitchen



# The Langdale

Immerse yourself in nature's own replenishing tones. Choose from two bedrooms or three to suit your brood.

For external CanExel™ Cladding option please visit [www.abiuk.co.uk](http://www.abiuk.co.uk)



For more information and to take a virtual tour, visit [www.abiuk.co.uk](http://www.abiuk.co.uk)

## All this included

- ✓ Matt finish Champagne aluminium cladding
- ✓ Pre-galvanised twin axle chassis
- ✓ White 'Low E' PVCu Thermaglass argon-filled double glazing
- ✓ Fully condensing boiler gas central heating
- ✓ Luxury wood burner style feature fire
- ✓ Carpet underlay throughout
- ✓ Free-standing dining table and chairs
- ✓ Satellite co-ax
- ✓ USB socket in lounge
- ✓ Scatter cushions in lounge
- ✓ Voiles throughout
- ✓ Soft-close hinges on doors and drawers in kitchen
- ✓ Luxury integrated electric oven and separate gas 5 burner hob
- ✓ 40mm worktops
- ✓ Integrated fridge freezer
- ✓ Externally vented powered cooker hood
- ✓ Lift-up bed in master bedroom
- ✓ TV point in all bedrooms
- ✓ USB sockets in all bedrooms
- ✓ King size bed in master bedroom (2 bedroom model only)

- ✓ Composite kitchen sink
- ✓ Plain duvet covers and pillowcases
- ✓ Bed runners and scatter cushions on all beds
- ✓ En suite shower (2 bedroom model only)
- ✓ En suite toilet
- ✓ Bathroom extractor fans
- ✓ Shaver socket
- ✓ Additional sockets next to TV point in lounge
- ✓ Hooks in all bathrooms
- ✓ Entrance hall and cloakroom
- ✓ Stylish pictures throughout
- ✓ Full front sliding door
- ✓ Crib 5 mattresses to all bedrooms

## Add any of these

- ☐ Residential specification BS3632
- ☐ Deluxe Bluetooth sound system
- ☐ 'Exclusive' pocket sprung mattresses
- ☐ Space saver bed for twin room
- ☐ Integrated washing machine
- ☐ Integrated dishwasher
- ☐ Integrated microwave oven
- ☐ Fully galvanised chassis
- ☐ CanExel™ exterior cladding
- ☐ Vinyl flooring in lounge in lieu of carpet

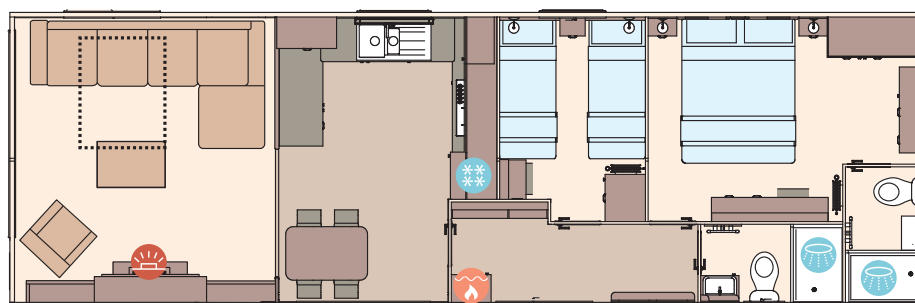

The Langdale 40ft x 13ft x 2 bedroom

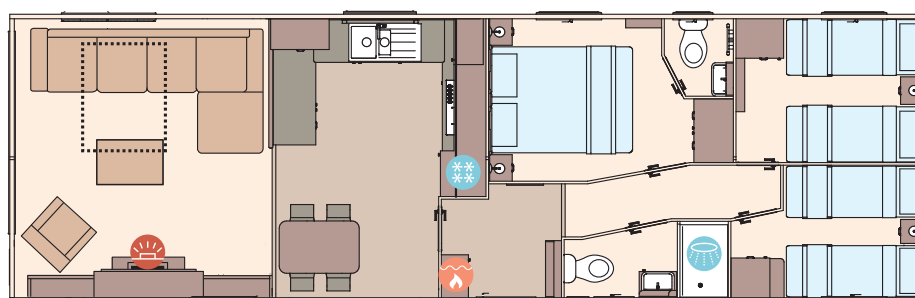

The Langdale 41ft x 13ft x 3 bedroom

## KEY:

- Fire
- Water heater
- Shower
- Fridge/Freezer
- Front pull out bed

OPTIONAL  
Residential  
specification  
BS3632  
See Page 86